



Euro Railways

Chocolate Train

Inside this issue:

Conditions	2
Refund policy	2
Price list	2
Reservations	2
Layout of cars	3

Montreux to Gruyeres

A panoramic trip from Montreux on the Swiss Riviera to Gruyères, home of the famous Gruyères cheese and the Nestlé chocolate factory. Chocolate sampling is included.

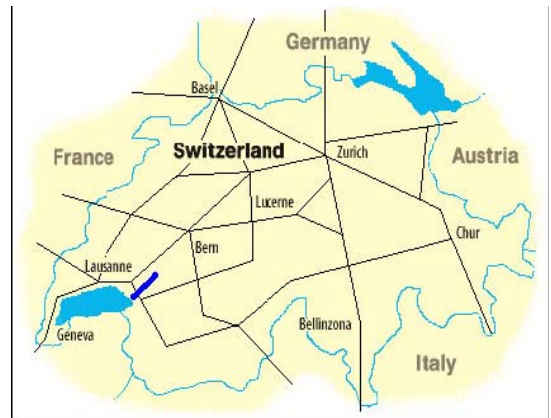

Features

- The Swiss Chocolate Train is a joint venture between GoldenPass Services and Cailler-Nestlé. Clients ride in the comfort of 1st class, in a Pullman “Belle Epoque” carriage vintage 1915 or the ultramodern panorama car, affording stunning views of the vineyards surrounding Montreux and medieval Gruyères. Depart Montreux on the Swiss Riviera, ascend to Gruyères, home of the famous Gruyères cheese and continue to Broc, where the chocolate factory is marvelous situated between Lake Gruyères and the Alps.
- Route: Montreux–Gruyères–Broc Fabrique- Montreux
- Service available: Every Monday and Wednesday from June to October except August 1st
- The reservation fee includes:-
 - Seat reservation in either a Pullman “Belle Epoque” or panoramic car
 - Coffee and croissants on the train
 - Bus from and to Gruyères train station
 - Admission into cheese factory and castle in Gruyères
 - Film presentation, factory visit and chocolate sampling at the Cailler-Nestlé chocolate factory

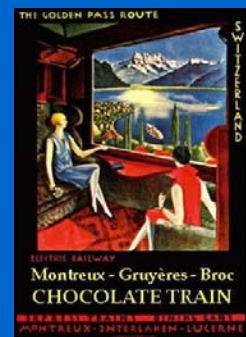

Schedules

Montreux– Gruyere– Broc Chocolate Factory– Montreux

Train#	2118		
Montreux (dep)	9h34	Gruyere (dep)	14h09
Gruyere (arr)	10h45	Broc Fabrique (arr)	14h31
		Broc Fabrique (dep)	15h50
		Montreux (arr)	17h52

Visit Gruyere and its castle, the cheese factory, free time for lunch (not included)

Film presentation, factory visit and chocolate sampling

Price List

Chocolate train	Price per person (US\$)
Seat reservation	\$ 22

Valid from 01/01/06 to 12/31/06, subject to change

Seat reservation for the Chocolate Train is compulsory and additional for all passengers

Traveling without a pass

- Ticket has to be paid locally (about \$50)

Reservations Entries:

- Manual entry in Euronet
- STATIONS: Montreux – Broc Fabrique
- Accommodation: seat
- Class: 1st class only
- POS: leave blank
- Train number: 2118 (valid for round-trip)

Traveling with any of the above mentioned passes in **2nd class**

- 1st class upgrade for the trip from Montreux to Broc has to be paid locally

Conditions

The entire trip Montreux - Broc and return is covered by the following 1st class passes:

- Swiss Pass
- Swiss Flexi Pass
- Swiss Youth pass
- Switzerland 'n Austria Pass
- France 'n Switzerland Pass
- Eurailpass
- Eurail Selectpass (incl. Switzerland)

Refund policy

- For tickets and passes, please refer to the relevant fact-sheet
- **Reservation fees are not refundable.**

Euro Railways
The Easiest Way to Discover Europe



<http://www.eurorailways.com>

Phone: 1-866-768-8927

International Phone: 1-954-509-0601

E-mail: callcenter@eurorailways.com

1611 NW 91st Ave

Suite 321

Coral Springs, FL - 33071

Layout of cars

Chocolate Train and Belle Epoque Cars



« Montreux



Broc »

Car 10 Belle Epoque
1st class 24 places
(Ars 101)

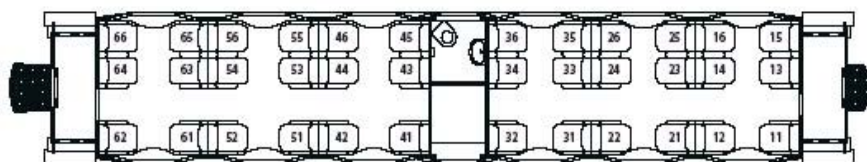
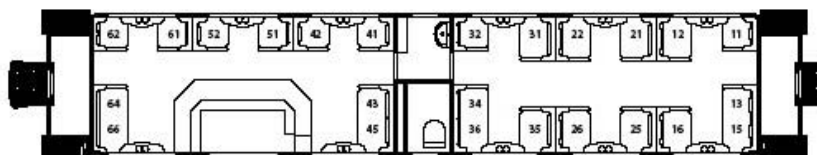

Car 11 Belle Epoque
1st class 36 places
(As 102)

Car 12 Panoramic
1st class 32 places
(As 118)

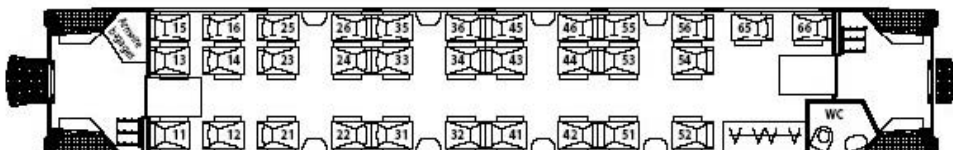

Layouts of compositions indicative, subject to modification

